

STEALTH HYBRID™

INTERCHANGEABLE SPECTACLE AND GOGGLE

TECHNICAL SPECIFICATION

PRODUCT CODE: ASA450-151-102

INTERCHANGEABLE SPECTACLE ARMS AND GOGGLE STRAP COMBINED WITH MULTIPLE LENSES MAKES THE STEALTH HYBRID™ A TRULY UNIVERSAL EYE PROTECTION SOLUTION

EYE & FACE PROTECTION

SPECTACLE ARMS:

Polycarbonate & Phthalate free PVC

FOAM:

EVA

GOGGLE STRAP:

Nylon + Elastic with Polycarbonate clips

FRAME:

Polycarbonate

LENS:

Polycarbonate

INSTRUCTIONS FOR USE

Ensure the correct eye protection is selected for the job about to be carried out. If unsure contact an expert

Make sure either the spectacle arms or goggle strap are connected properly before donning the Stealth Hybrid™

Ensure that the safety spectacles or goggles are in place, before entering the hazard area

In use ensure that the safety spectacles or goggles fit comfortably and securely on the head

STEALTH HYBRID™ PERFORMANCE

Optical Quality Class 1 polycarbonate lens with K & N Anti-Mist & Anti-Scratch protective coating

Flexible design that provides protection against impact, UV, and reduces the ingress of Dust and Airborne particles

When used with the spectacle arms the Stealth Hybrid™ provides F grade spectacle impact protection or attach with the headband to upgrade to B grade impact goggle protection

With spectacle arms attached: Lens and frame offer protection against low energy high-speed particles at 45m/s (101mph).

With headband attached: Lens and frame offer protection against medium energy high-speed particles at 120 m/s (270mph)

EN166.1.F & EN170. Tested to resist the impact of a 6mm (1/4") steel ball fired at 100mph (160kph) at the lens

CLEANING & MAINTENANCE

The Stealth Hybrid™ may be cleaned with soap and warm water and dried with a soft cloth

Do not clean with chemical or abrasive cleaners

The Stealth Hybrid™ should be stored out of direct sunlight, away from chemicals and not exposed to extremes of temperature

STEALTH HYBRID™ FEATURES & BENEFITS

Stealth Hybrid™ combines the advantages of a spectacle and goggle

Quick release spectacle arm / strap design allows easy change between Spectacle arms and Goggle strap

Eva foam seal provides close fit for maximum dust and particle protection and all-day comfort

9.75C Lens design offers superior fit and maximum peripheral field of vision

Pantoscopic Angle adjustment allowing the Stealth Hybrid™ frame to be angled to offer a customized fit

Interchangeable lens design allows users to change the lens according to different applications

Lenses are coated with KN Anti-mist & Anti-scratch technology to provide tough scratch resistance and exceptional anti-misting

CONFORMITY

Conforms to EN 166 (1.F Spectacle & 1.B Goggle) & EN 170

Also meets ANSI Z87.1

EC Certificate Number 0726, issued by Inspec Certification Limited

STEALTH HYBRID™

INTERCHANGEABLE SPECTACLE AND GOGGLE

**TECHNICAL
SPECIFICATION**

PRODUCT CODE: ASA450-151-102

INTERCHANGEABLE SPECTACLE ARMS AND GOGGLE STRAP COMBINED WITH MULTIPLE LENSES
MAKES THE STEALTH HYBRID™ A TRULY UNIVERSAL EYE PROTECTION SOLUTION

EYE & FACE PROTECTION

DIMENSIONS OF STEALTH HYBRID™

FRAME & LENS

Lens Thickness: 2mm

Lens Size (Vertical): 46mm

Lens Size (Diagonal): 77mm

Bridge: 10mm

Frame Width: 149mm

STEALTH HYBRID™ Spectacle

Spectacle Arm Length: 121mm

Overall Length (Lens to tip): 160mm

Closest point between temple tips: 77mm

Weight of Spectacle: 37g (Approx.)

STEALTH HYBRID™ Goggle

Strap Length Min: 293mm

Strap Length Max: 500mm

Weight of Goggle: 40g (Approx.)

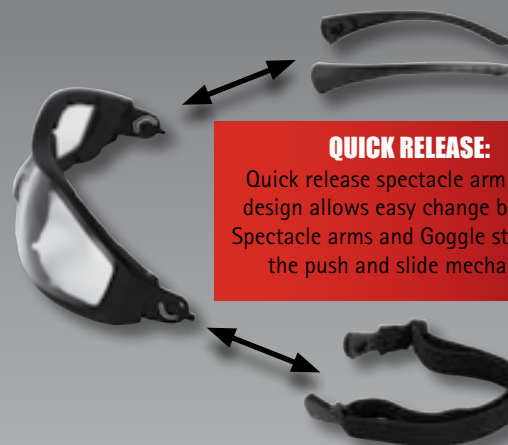

QUICK RELEASE:

Quick release spectacle arm / strap design allows easy change between Spectacle arms and Goggle strap with the push and slide mechanism



DIMENSIONS OF OUTER PACKAGING

Quantity: 1

Weight: 83g (Approx.)



HEIGHT:
70mm

WIDTH:
55mm

LENGTH:
150mm

MARKINGS

Frame: Spectacle: EN166 1.FT Goggle: EN166 1.B

Clear Lens: EN 170 2-1.2 1.F.K.N

LIMITATIONS OF USE

Protection will only be offered if the safety spectacles or goggles are fitted correctly

If the safety spectacles or goggles become scratched or damaged they should be replaced, likewise if the safety spectacles or goggles are subjected to severe impact they should be replaced immediately

Do not apply paint, solvents, adhesives or self-adhesive labels, except in accordance with instructions from the manufacturer

The safety spectacles or goggles, when in contact with the skin may cause allergic reactions to susceptible individuals. If this occurs leave the hazard area, remove the eye shield and seek medical advice

The attention of users is also drawn to the dangers of modifying or removing any of the original component parts, other than as recommended by the manufacturer

The Stealth Hybrid™ is not suitable for protection against dusts, liquids or molten metals